

# SOUTHEASTERN

BAPTIST THEOLOGICAL  
SEMINARY

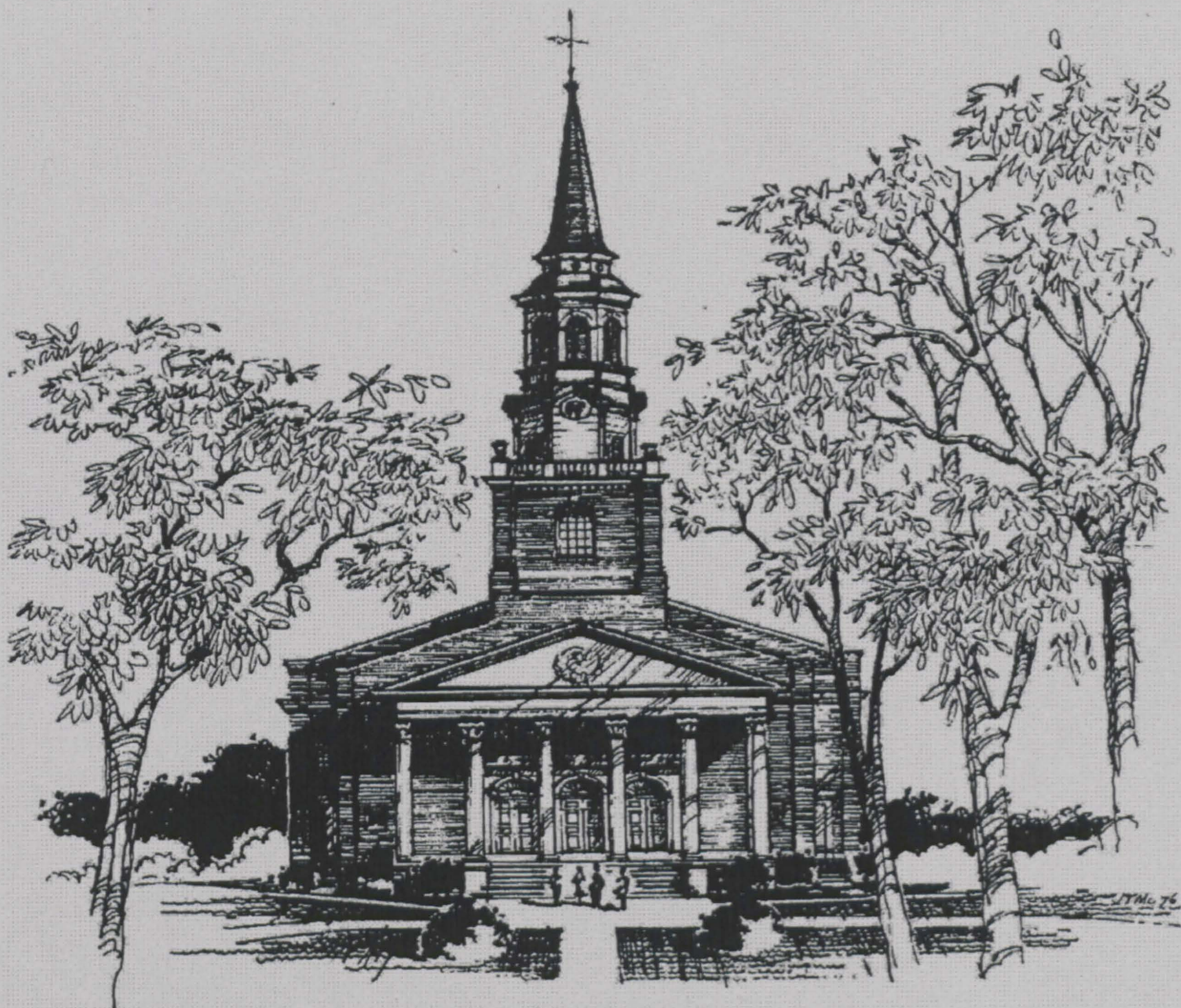

## NORFOLK EXTENSION 2000/2001 STUDENT HANDBOOK







## Statement of Institutional Purpose

Southeastern Baptist Theological Seminary is an institution of higher learning established and supported by the Southern Baptist Convention in order to assist Southern Baptist churches by preparing God-called men and women for Christian ministry through theological education and practical training. Southeastern maintains an administration and faculty whose convictions and calling reflect consistent adherence to the institution's *Abstract of Principles*. Southeastern's administration and faculty are qualified by personal commitment to Christ, by academic preparation, and by personal and professional experience to provide guidance in spiritual, intellectual, and practical endeavors.

Through its administration and faculty, Southeastern offers programs of instruction and personal disciplines, preparing men and women for Christian ministry and service consistent with the 2000 *Baptist Faith and Message* in churches, on mission fields, in schools, colleges, and seminaries, and through other Christian ministries throughout the world. Southeastern's purpose is implemented through campus-based and off-campus programs of academic studies and practical preparation for ministry.

**Academic Studies** – Southeastern seeks to prepare men and women by helping them discern, defend, and proclaim God's revealed truth. Southeastern pursues high academic standards in providing courses of study for understanding the Bible and the history, content, and contemporary relevance of the Christian faith. Southeastern is committed to the complete inerrancy and sufficiency of the Bible as the foundation for effective Christian ministry and service.

**Practical Preparation** – Southeastern emphasizes a wholesome, intelligent, and intentional evangelism in obedience to Christ's commission to make disciples of all people. Spiritual development in Christ-likeness through Bible-based theological studies will produce a compassionate desire to minister to the human suffering caused by individual, social, and spiritual evils. Southeastern provides practical preparation for a wide variety of Christian ministries, with special focus on proclaiming the Gospel and extending the ministry and influence of the local church.



The following text is extremely faint and illegible. It appears to be a multi-paragraph document, possibly a report or a letter, but the content cannot be discerned due to the low contrast and blurriness of the scan.

**SOUTHEASTERN**  
BAPTIST THEOLOGICAL  
SEMINARY



Dr. N. Allan Moseley

Vice President for Student Services  
Dean of Students

II Timothy 3:17

General Information

The location of the Norfolk Extension of Southeastern Baptist Theological Seminary is the First Baptist Church of Norfolk. The address is 313 Kaysville Road, Norfolk, VA 23502-4724. The pastor of the church is Dr. John Powers. The seminary contact person at the church is Rev. Dick Baker, Minister of Education. The church phone number is 757-461-3220.

Security and Emergency Messages

## Welcome to the Southeastern family!

Like all families, Southeastern Seminary is a group of folks who love one another. Also, like a family, we are proud of every new addition, so we are glad you have become part of us by attending the Norfolk Extension. Families are also loyal, and we approach our relationship with you with the belief that Southeastern is the best way on the planet to prepare for Christian ministry.

Families also have guidelines for behavior. We have reduced our expectations to writing, and they are contained in this handbook. In addition, we have included descriptions of services and general information about the Norfolk Extension. We even placed some information about the main campus in Wake Forest, thinking that the Lord may yet call you to experience on-campus theological education. The purpose of all this is to help you make the most of the opportunity of growth and learning that is before you. If the information you are looking for is not in this handbook, check the seminary catalog or the appropriate administrative office.

Remember, seminary days don't last forever (hopefully!), so make the most of this time. Study hard, learn as much as possible, build relationships with fellow students that will last a lifetime, and be involved in ministry. These days will be gone before you know it, so don't miss anything! And welcome to the family.

Allan Moseley

P.O. Box 1889  
Wake Forest, NC 27588-1889  
telephone 919-863-8306 || 919-863-8112 facsimile  
Email: amoseley@sebts.edu



SOUTHEASTERN  
BAPTIST THEOLOGICAL  
SEMINARY

Dr. M. Allen Morley  
Vice President for Academic Affairs  
Lynchburg, Virginia  
22802-3300

## Welcome to the Southeastern family!

The Southeastern Theological Seminary is a group of folks who love the gospel. Also, this family was not created overnight, so we are glad you have become part of us by joining the Southeastern family. Therefore, we also feel that we should establish a relationship with you and we believe the best way to do this is to provide you with the best of our resources.

Finally, the new guidelines for behavior. We have received our expectations to writing and they are contained in the handbook. In addition, we have received descriptions of articles and general information about the journal's mission. We have placed extra information about the journal in the front of the handbook and the new journal for review and on-boarding. The purpose of all this is to help you make the most of the opportunity in front of you and to help you. If the information you are looking for is not in the handbook, check the website and give the appropriate administrative office.

Remember, Southeastern is not just a name, it is a mission. To make the most of this time, study hard, work hard, and build relationships with fellow students that will last a lifetime and be involved in ministry. These days will be gone before you know it, so don't miss anything. God bless you to the end.

M. Allen Morley

## Student Services: Personal and Family

### General Information

The location of the Norfolk Extension of Southeastern Baptist Theological Seminary is the First Baptist Church of Norfolk. The address is 312 Kempsville Road, Norfolk, VA 23502-4726. The pastor of the church is Dr. John Powers. The seminary contact person at the church is Rev. Dick Baker, Minister of Education. The church switchboard number is 757-461-3226.

### Security and Emergency Messages

First Baptist Church of Norfolk employs security personnel who patrol the church's campus regularly. When Southeastern's classes are meeting, a security staff member will usually be on duty. All entrances are locked and monitored by security personnel.

Office hours at First Baptist Church are 8:00 AM to 5:00 PM, Monday to Friday. During office hours, in order to deliver an emergency message to a student, family or friends should call the church switchboard at 757-461-3226. After office hours, security personnel will answer the switchboard number and refer calls. Security will also be on duty at the secured entrance to assist in case of emergency. If students need emergency medical care, they should call 911 or be transported to the Lee Hospital located near the church.

### Family Crisis Communication

One of the advantages of being part of a Christian community like a seminary is the readily available prayer support for persons who experience a crisis in their lives. Southeastern has devised a family crisis communication procedure to provide a way for the seminary administration to be aware of crises that arise in the Southeastern family. If you are aware of a serious illness, accident, major material loss, birth, death in the immediate family, or other situations that should be communicated, you may call the Dean of Students' Office at 919-863-8306 and report this information. The prayer request will then be communicated by e-mail immediately to all major offices and areas of the campus, and the seminary family will be asked to pray for each emergency situation.

### Building Layout

To find out the location of a class, students may call Rev. Dick Baker one week before the first class meeting. If the location of the class changes at any point during the semester, students will be notified. At the first class session, Rev. Baker will inform students where to find changes in class locations.

## Student Services: Personal and Family

### General Information

The location of the Norfolk Extension of Southern Baptist Theological Seminary is the First Baptist Church of Norfolk. The address is 715 Kempsville Road, Norfolk, VA 23502-4118. The pastor of the church is Dr. John P. Foster. For emergency contact purposes the church is Rev. Dick Baker, Director of Education. The church's telephone number is 757-461-4124.

### Security and Emergency Messages

The First Baptist Church of Norfolk employs security personnel who patrol the church's campus regularly. When Southern's classes are meeting, a security staff member will usually be on duty. All entrances are locked and monitored by security personnel.

Office hours at First Baptist Church are 9:00 AM to 5:00 PM, Monday to Friday. During office hours, in order to deliver an emergency message to a student, family or friend, please call the church switchboard at 757-461-4124. After office hours, security personnel will answer the phone in case of an emergency. If students need emergency medical care, they should call 911 or be transported to the J. Geis Hospital located near the church.

### Family Contact Information

One of the advantages of being part of a Christian community is a family in the nearby area. Available phone numbers for persons who experience a crisis in their lives. Southern has developed a family crisis communication protocol to provide a way for the security administration to be aware of other life crises in the Deepwater family. If you are aware of a serious illness, accident, major marital loss, birth, death in the immediate family, or other emergency, please contact the Family Crisis Team at Southern, Office at 919-957-8242 and report this information. The person reporting will then be communicated by e-mail immediately to all major offices and areas of the campus, and the emergency family will be asked to pay for each emergency situation.

### Religious Liberty

To find out the location of a class, students may call Rev. Dick Baker one week before the first class meeting. If the location of the class changes at any point during the semester, students will be notified. At the first class session, Rev. Baker will inform students where to hold classes and class locations.



## Registering for Classes

Students should be officially admitted to the seminary before the beginning of the semester in which they enroll in a particular class. This admittance requires completion of an application for admission and acceptance by Southeastern's Office of Admissions. An application for admission can be obtained from that office. Students who have not been officially admitted prior to the class in which they wish to enroll will be given a non-degree admission form at the first class session. This will be completed by the student and mailed to Southeastern by the seminary contact person, Rev. Baker.

Just prior to the first class meeting, student photos will be taken, students will complete a survey form, and books will be purchased. Students will also pay all fees at the first class. If students are not prepared to pay at the first class, they may make arrangements with Rev. Baker to pay before the second class meeting. If fees are not paid by the second class meeting, the student may not continue in the class.

## Purchase of Textbooks

Before the first meeting of each class, at the beginning of each term, a representative from Lifeway Christian Resources Bookstore in Norfolk will be present to sell course textbooks. Students should come to the first class meeting prepared to pay for all textbooks as well as tuition and fees for the class(es) for which they are enrolled.

## Library Resources

Southeastern Seminary has a fraternal relationship with the library at Regents University of Norfolk and Southeastern students may use resources at that library at no cost except that books may not be checked out.

The library at Southeastern Seminary is also available for extension center students. By accessing the library web site at <http://library.sebts.edu>, you may search the on-campus library for available books by clicking on search the Catalog. You may also utilize "first search." This program will allow you to look for magazine articles and other resources. After finding the needed book and checking for availability, an extension center student may email Judy Durham to check on having that book mailed directly to them. Her information may be found on the same web site by clicking "library staff" located under Information. By properly utilizing the available resources, an extension center student has access to every resource an on-campus student does. For more information, contact Judy Durham by phone at 919-863-8251 or through email at [jdurham@sebts.edu](mailto:jdurham@sebts.edu).

## Financial Aid

Southeastern's financial aid is based on the premise that students are making an effort to be as self-supporting as possible. It is recommended that students should have sufficient funds or income to see themselves through at least the first semester before seeking aid.

## Registering for Classes

Students should be officially admitted to the semester before the beginning of the semester in which they enroll in a particular class. This admission requires completion of an application for admission and acceptance by Southern's Office of Admissions. An application for admission can be obtained from that office. Students who have not been officially admitted prior to the class in which they wish to enroll will be given a non-degree admission form at the first class session. This will be completed by the student and mailed to Southern by the temporary contact person. See below.

Just prior to the first class meeting, student names will be taken. Students will complete a survey form and books will be purchased. Students will also pay all fees at the first class. If students are not prepared to pay at the first class, they may make arrangements with the Registrar to pay before the second class meeting. It is not the intent of the second class meeting, the student may not remain in the class.

## Purchase of Textbooks

Before the first meeting of each class, at the beginning of each term, a representative from the Registrar's Office will be present to sell course textbooks. Students should come to the first class meeting prepared to pay for all textbooks as well as tuition and fees for the class(es) for which they are enrolled.

## Library Resources

Southern's libraries has a strong relationship with the library in Jackson, Mississippi. The staff and Southern's librarians provide resources at the library at an hour, though that hours may not be extended.

The library at Southern's Southern is also available for extension users. Students may access the library with their library card. You may search for on-campus library for available books by checking the online Catalog. You may also check the online. The program will show you to look for negative articles and other resources. After finding the needed book and checking for availability, an extension user may email their request to check on having that book mailed directly to them. Her information may be found on the page with the by clicking "library user" located under information. By properly utilizing the website resources, an extension user student has access to every resource on an on-campus student does. For more information, contact your librarian by phone at 919-363-3331 or through email at [librarian@spk.edu](mailto:librarian@spk.edu).

## Financial Aid

Southern's financial aid is based on the promise that students are making an effort to be self-supporting as possible. It is recommended that students should have sufficient funds or income to see Southern through at least the first semester before seeking aid.

Almost all of Southeastern's financial aid is reserved for full-time, on-campus students. Usually, extension students have not left their sources of income to settle in Wake Forest, so they are usually in a better position to meet the financial requirements of higher education. Financial assistance for on-campus students includes: 1. Off-campus and on-campus jobs through Southeastern's Employment Services Office, 2. Ministry positions through the Ministry Referral Office, 3. Emergency Assistance, 4. Scholarships, and 5. Matriculation Deferment Plan.

With the exception of emergency assistance, students applying for these sources of aid must be enrolled full-time in a degree program. Applications for emergency assistance will be considered on a case by case basis.

### Motels and Restaurants Convenient to First Baptist Church

The following pages provide a map of the location of First Baptist Church with a listing of motels within a half-mile of the church, and of restaurants with addresses and distances from First Baptist. A third insert provides a layout of the third floor area of the First Baptist facilities where seminary classes are scheduled.

RESTAURANT	ADDRESS	PHONE # & DISTANCE	
Ramada Restaurant	6330 Newtown Rd	(757) 461-0400	0.2
Adam's	6360 Newtown Rd	(757) 461-2392	0.2
Willie's Bar & Grill	6360 Newtown Rd	(757) 466-8590	0.2
China Garden Express	1105 Newtown Rd	(757) 456-0001	0.3
Mc Donald's	745 Newtown Rd	(757) 461-3050	0.3
One Dollar Chinese	1105 Newtown Rd	(757) 490-1358	0.3
Surf Rider West	723 Newtown Rd	(757) 461-6488	0.3
Wendy's	725 Newtown Rd	(757) 466-9370	0.3
Shadow's	192 Ballard Ct	(757) 490-9098	0.4
Ashley's On Greenwich	5655 Greenwich Rd	(757) 499-6345	0.5
Zacharys	6160 Kempsville Cir # 104a	(757) 455-6351	0.5
Zero's Subs	5602 Princess Anne Rd # 4	(757) 497-8252	0.5
Fung Lin Restaurant	5635 Princess Anne Rd	(757) 499-3580	0.5
Burger King	5572 Princess Anne Rd	(757) 499-8335	0.7
Bamboo Hut	6400 E Virginia Beach Blvd	(757) 455-6002	0.7
Pastavita Italian Restaurant	6400 E Virginia Beach Blvd	(757) 459-2630	0.7
Shrimpboat Restaurant	6400 E Virginia Beach Blvd	(757) 461-6515	0.7
Zero's Subs	6116 E Virginia Beach Blvd	(757) 466-1741	0.8

Almost all of Southeastern's financial aid is awarded for full-time, on-campus students. Usually, extensive students have not left their sources of income to settle in Wake Forest, so they are usually in a better position to meet the financial requirements of higher education. Financial assistance for on-campus students includes: 1. Off-campus and on-campus jobs through Southeastern's Employment Services Office; 2. Ministry positions through the Ministry Relations Office; 3. Emergency Assistance; 4. Scholarships; and 5. Student Loan Department Plan.

With the exception of emergency assistance, students applying for these sources of aid must be enrolled full-time in a degree program. Applications for emergency assistance will be considered on a case-by-case basis.

**Private and Business Conventions to First Baptist Church**

The following pages provide a map of the location of First Baptist Church with a listing of private and business conventions of the church and of restaurants with addresses and distances from First Baptist Church. A third sheet provides a layout of the land floor area of the First Baptist facilities where many classrooms are located.

RESTAURANT	ADDRESS	PHONE # & DISTANCE
Anchor Restaurant	6130 Newwood Rd	(757) 461-0400 0.2
Anchor	6300 Newwood Rd	(757) 461-2392 0.2
White Horse Grill	6700 Newwood Rd	(757) 466-2390 0.3
Clubs Garden Express	1185 Newwood Rd	(757) 466-6031 0.3
Joe's Diner	745 Newwood Rd	(757) 461-2066 0.3
Our Table Cafe	1102 Newwood Rd	(757) 461-1222 0.3
Starbucks	725 Newwood Rd	(757) 461-0668 0.3
Franks	725 Newwood Rd	(757) 466-2320 0.3
Shelby's	102 Jubal Ct	(757) 466-9022 0.4
Anthony On Greenway	5675 Greenway Rd	(757) 499-6212 0.5
Zachary's	6100 Kappaville Ct # 104	(757) 462-6221 0.5
Zoe's Cafe	5025 Virginia Ave Bldg 4	(757) 497-8222 0.5
Foxy LLC Restaurant	5675 Frances Anne Rd	(757) 499-0260 0.5
Burger King	5675 Frances Anne Rd	(757) 499-8292 0.5
Bonnie Hill	4405 E Virginia Beach Blvd	(757) 422-0002 0.7
Francis Plaza Restaurant	6405 E Virginia Beach Blvd	(757) 422-2230 0.7
Southern Restaurant	6405 E Virginia Beach Blvd	(757) 461-6212 0.7
Zoe's Cafe	6110 E Virginia Beach Blvd	(757) 466-1241 0.8

Bambino's Restaurant	1011 Kempsville Rd	(757) 466-0688	0.8
Arby's	6012 E Virginia Beach Blvd	(757) 461-1195	0.8
Rally's Hamburgers Inc	935 Vulcan Dr	(757) 455-5854	0.9
China Sea Buffet	5957 E Virginia Beach # 29	(757) 461-7799	0.9
Olive Garden	5920 E Virginia Beach Blvd	(757) 455-5875	1.0
Lunch Box	5720 Sellger Dr	(757) 466-7647	1.0
Pizzeria Uno	5900 E Virginia Beach Blvd	(757) 466-0923	1.0
Lone Star Steakhouse	450 N Military Hwy	(757) 466-0124	1.1
Boston Market	472 N Military Hwy	(757) 461-2400	1.1
El Rodeo	5834 E Virginia Beach Blvd	(757) 466-9077	1.1
Piccadilly Cafeteria	530 N Military Hwy	(757) 461-2477	1.1
Schlotsky's Deli	700 N Military Hwy	(757) 455-2867	1.1
China Garden Restaurant	854 N Military Hwy	(757) 461-3818	1.2
Mc Donald's	5761 E Virginia Beach Blvd	(757) 461-1770	1.2
Pizza Hut	5751 E Virginia Beach Blvd	(757) 461-9107	1.2

0.8	(757) 466-0883	1611 Kempsville Rd	Yannone's Restaurant
0.8	(757) 461-1192	6012 E Virginia Beach Blvd	Yates
0.9	(757) 451-5254	932 Wilcox Dr	Yates & Associates Inc
0.9	(757) 461-7390	2521 E Virginia Beach # 29	Yates Sea Buffet
1.0	(757) 452-2272	3100 E Virginia Beach Blvd	Yates Seafood
1.0	(757) 466-7867	2520 Soligo Dr	Yates Seafood
1.0	(757) 466-0679	3000 E Virginia Beach Blvd	Yates Seafood
1.1	(757) 466-6129	450 N Military Hwy	Yates Seafood
1.1	(757) 461-2400	41214 Military Hwy	Yates Seafood
1.1	(757) 466-9077	2521 E Virginia Beach Blvd	Yates Seafood
1.1	(757) 461-2277	300 N Military Hwy	Yates Seafood
1.1	(757) 452-2237	700 N Military Hwy	Yates Seafood
1.2	(757) 461-3814	451 N Military Hwy	Yates Seafood
1.2	(757) 461-1720	3701 E Virginia Beach Blvd	Yates Seafood
1.2	(757) 461-9107	4721 E Virginia Beach Blvd	Yates Seafood

Hotels located within a half mile  
of First Baptist Church of Norfolk

## Restaurants located within 5 minutes of First Baptist Church of Norfolk

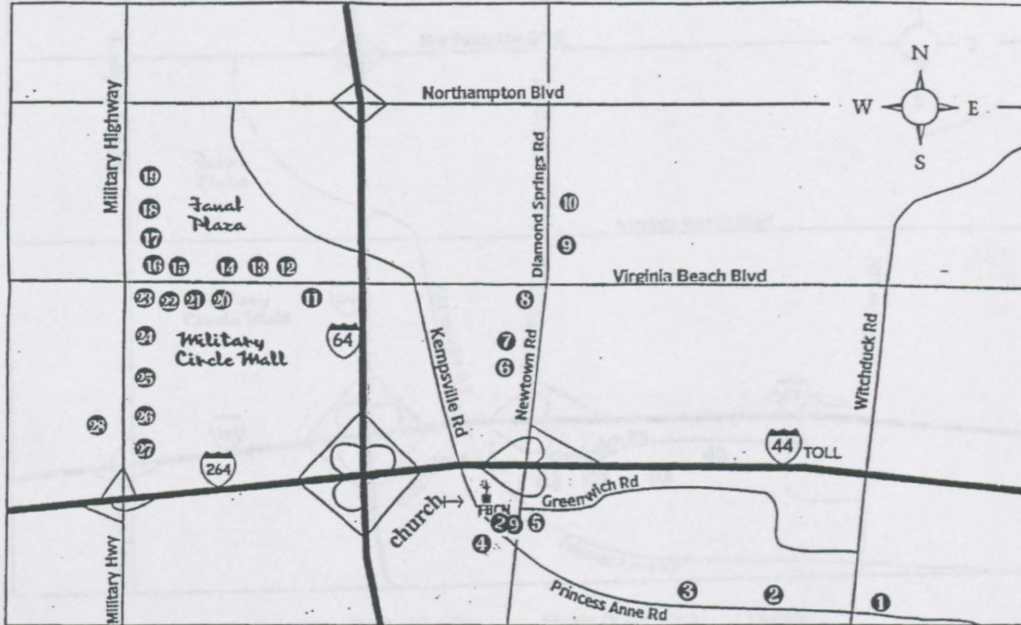

- |                 |                         |                       |                  |                           |
|-----------------|-------------------------|-----------------------|------------------|---------------------------|
| 1. Ragazzi's    | 7. McDonald's           | 13. Olive Garden      | 19. Chi-Chi's    | 25. Scholotzsky's         |
| 2. Taco Bell    | 8. Shoney's             | 14. Subway Sandwiches | 20. McDonald's   | 26. Wendy's               |
| 3. Burger King  | 9. Golden Corral        | 15. Steak & Ale       | 21. Taco Bell    | 27. Lone Star Steak House |
| 4. China Palace | 10. Kent. Fried Chicken | 16. Applebee's        | 22. Pizza Hut    | 28. Carlos Murphy's       |
| 5. Denny's      | 11. Rallys Hamburgers   | 17. Uno (Pizza)       | 23. Bennigan's   | 29. Odyssey               |
| 6. Wendy's      | 12. Arby's Roast Beef   | 18. Darryl's          | 24. China Garden |                           |

Restaurants located within 5 miles  
of First Baptist Church of Norfolk



Restaurant Name	Address	Phone Number
1. ...	...	...
2. ...	...	...
3. ...	...	...
4. ...	...	...
5. ...	...	...
6. ...	...	...
7. ...	...	...
8. ...	...	...
9. ...	...	...
10. ...	...	...
11. ...	...	...
12. ...	...	...
13. ...	...	...
14. ...	...	...
15. ...	...	...
16. ...	...	...
17. ...	...	...
18. ...	...	...
19. ...	...	...
20. ...	...	...



## Hotels located within a half mile of First Baptist Church of Norfolk

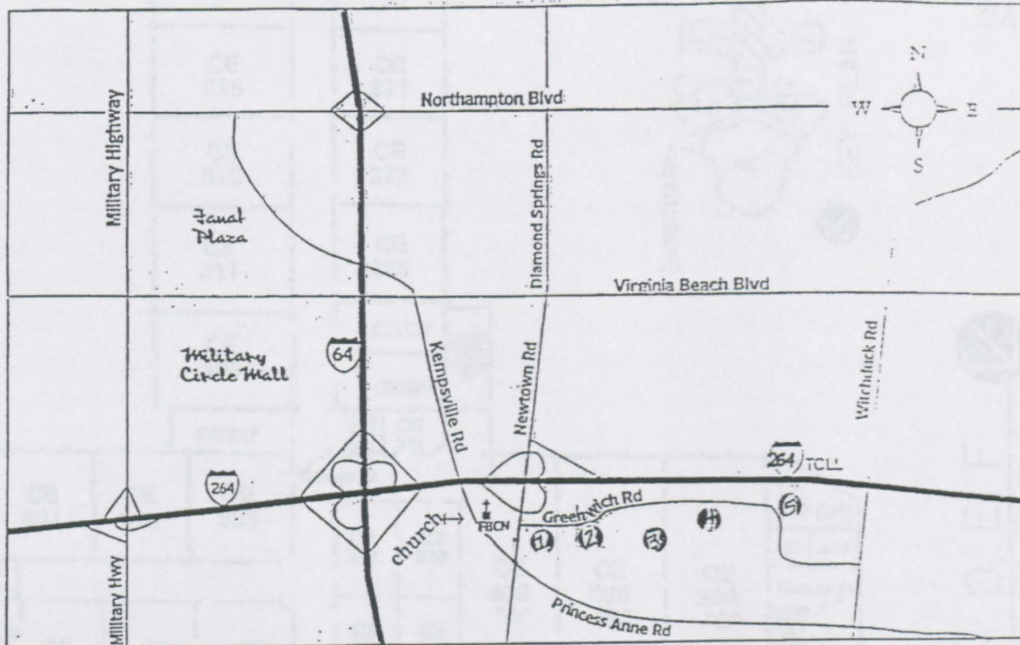

- |   |   |                              |
|---|---|------------------------------|
| 1. LaQuinta Inn (757) 497-6620<br>192 Newtown Road<br>Va Beach, VA 23462          | Single (King Size)<br>\$59.95 plus tax    | Double<br>\$72.00 plus tax   |
| 2. Hampton Inn (757) 490-9800<br>5793 Greenwich Rd.<br>Va Beach, VA 23462         | Single (King Size)<br>\$78.00 plus tax    | Double<br>\$78.00 plus tax   |
| 3. Red Roof Inn (757) 490-0225<br>196 Ballard Street<br>Va Beach, VA 23462        | Single (King Size)<br>\$52.95 plus tax    | Double<br>\$70.00 plus tax   |
| 4. Holiday Inn (757) 499-4400<br>5655 Greenwich Road<br>Va Beach, VA 23462        | Single (King Size)<br>\$81.00 plus tax    | Double<br>\$81.00 plus tax   |
| 5. Courtyard Marriott (757) 490-2002<br>5700 Greenwich Road<br>Va Beach, VA 23462 | Single (King Size)<br>\$80- \$90 plus tax | Double<br>\$85-\$95 plus tax |

Hotels located within a half mile  
of First Baptist Church of Norfolk



Hotel Name	Address	Phone Number
1. Colonial Hotel	100 Broad Street	235-1234
2. Hampton Hotel	150 Market Street	235-5678
3. Norfolk Hotel	200 State Street	235-9012
4. First Baptist Hotel	50 First Baptist Church	235-3456
5. Grand Central Hotel	120 Broad Street	235-7890



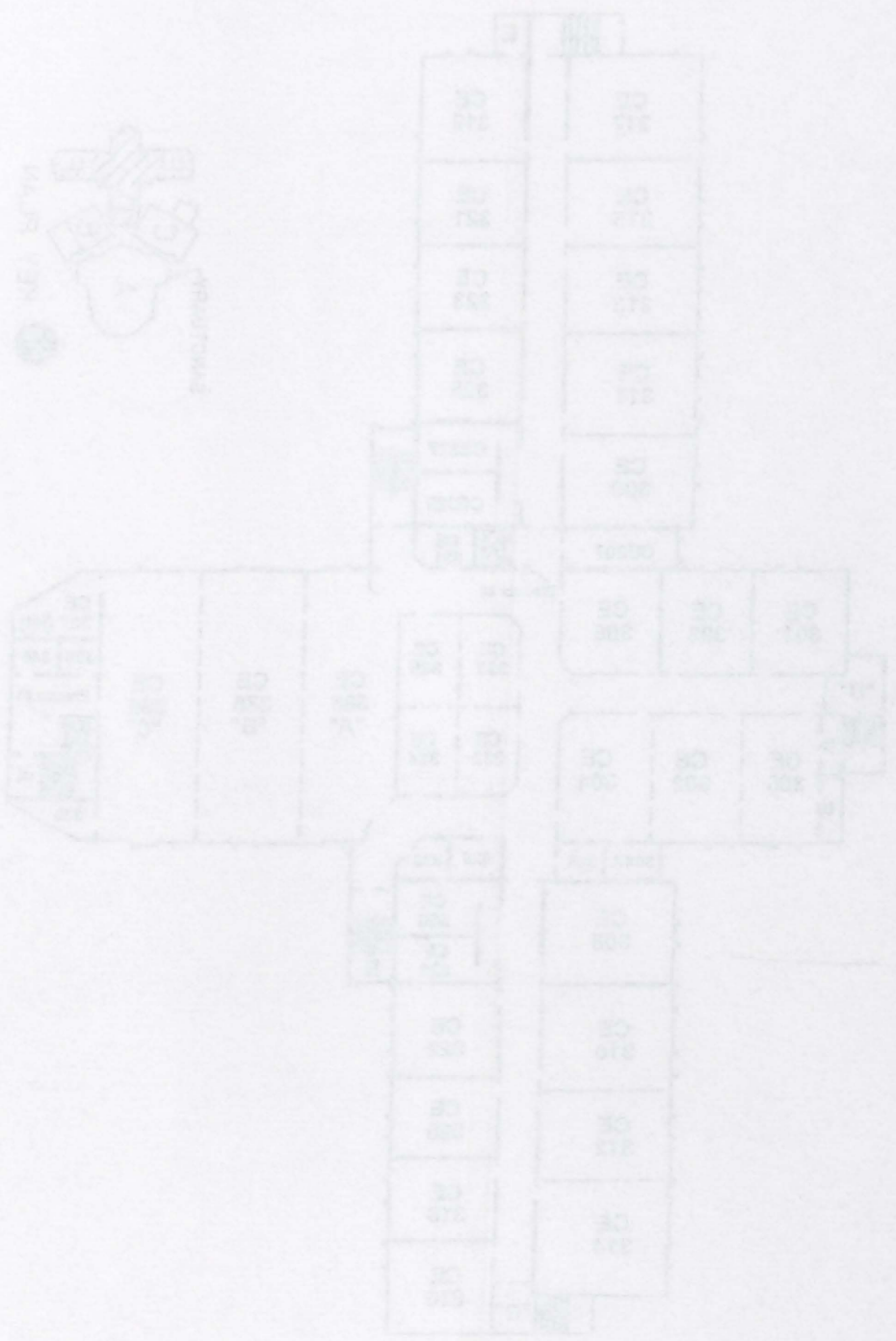

Э. Д. О. - ИА. Д. Р. 1900. Д. О. Д. П. П. Т.

МАШИНА

## Wellness and Recreation

The First Baptist Church does not have recreational facilities available to Extension students.

### I.D. and Activity Cards

An I.D. card is issued to each new student upon entering Southeastern. This card will serve a number of functions and should be carried at all times. In addition to identifying a person as a Southeastern student, it is required to check out books and other materials from the Library. An identification card will also be required before recreational facilities and equipment can be used.

For an extension center student to receive a valid Southeastern ID, you must make arrangements to have a jpeg image of yourself sent electronically to Southeastern. This may be accomplished through an email sent to Thomas White at [twhite@sebts.edu](mailto:twhite@sebts.edu). The image may not be over 150 kb in size. Along with the image, you must also send an email requesting an ID. This email must have your full name, your student number, your telephone number, and the address to which you would like your ID to be mailed. You will be notified electronically once your ID has been mailed. If you do not have access to electronic mail, please call 919-863-8309 to arrange for processing your ID. An ID Card will only be necessary if you plan to utilize the library or student center located at the main campus of Southeastern Seminary.

An I.D. card is valid during periods of continuous enrollment. Cards become void when a student's enrollment terminates or is interrupted. I.D. cards are provided at no charge, but a \$10.00 charge will be made to replace lost cards. Replacements are made at the Student Life Office in the Ledford Center. For any other questions concerning ID Cards, please call Thomas White at 919-863-8309 or email him at [twhite@sebts.edu](mailto:twhite@sebts.edu).

### Student Excursions

The seminary regularly sponsors off campus trips for ministry, personal enrichment and academic credit. Extension center students are eligible to participate in these excursions. The three primary types of seminary sponsored excursions are mission trips, Holy Land trips, and conferences. Student behavior during such travel opportunities is required to be consistent with both the purpose of the trip and the established policies of the seminary. If the purpose of the excursion is mission work, students will be available at all times to do mission work. If the purpose of the excursion is archaeological work, students will apply themselves to their work. If the purpose of the excursion is attendance of a conference and/or seminars, students will attend all such meetings.

While on mission trips, students are expected to comply with the standards of conduct and dress that are appropriate for Christians in the culture in which they are serving. Students are also expected to sign any waivers that are applicable to their work and travel. When work is to be done on any school trip, students are expected to work diligently, without complaining. All conduct that is prohibited in this handbook in the section dealing with discipline is also prohibited on student excursions. Fraternization with the opposite sex is forbidden. All seminary-sponsored excursions will be accompanied by a member of the faculty or administration of the seminary. When such trips are for academic credit, students are responsible to meet the academic requirements specified by the supervising professor.

The first major Church does not have recreational facilities available to Extension students.

LD and Activity Cards

An LD card is issued to each new student upon entering Southeastern. This card will serve a number of functions and should be carried at all times. In addition to identifying a person as a Southeastern student, it is required to check out books and other materials from the Library. An identification card will also be required before recreational facilities and equipment can be used.

For an extension course student to receive a valid Southeastern ID, you must make arrangements to have a mug image of yourself sent electronically to Southeastern. This may be accomplished through an email sent to [Western@seu.edu](mailto:Western@seu.edu). The image may not be over 150 KB in size. Along with the image, you must also send an email requesting an ID. This email must have your full name, your student number, your telephone number, and the address to which you would like your ID to be mailed. You will be notified electronically once your ID has been mailed. If you do not have access to electronic mail, please call 919-683-8309 to arrange for processing your ID. An ID card will only be necessary if you plan to utilize the library or student center located at the main campus of Southeastern University.

An ID card is a valuable means of obtaining enrollment. Cards become void when a student's enrollment terminates or is interrupted. ID cards are provided at no charge for a \$10.00 charge with the mail to request lost cards. Replacements are made at the Student Life Office in the Student Center. For any other questions concerning ID Cards, please call Thomas White at 919-683-8309 or email him at [twwhite@seu.edu](mailto:twwhite@seu.edu).

Student Excursions

The student regularly sponsors all campus trips for ministry, personal enrichment and academic credit. Excursion teams and are eligible to participate in these activities. The first priority of student sponsored excursions are mission trips (Holt, Land, and other) and conferences. Student behavior during such travel opportunities is expected to be consistent with the purpose of the trip and the established policies of the company. If the purpose of the excursion is mission work, students will be available at all times to do mission work. If the purpose of the excursion is archaeological work, students will apply themselves to their work. If the purpose of the excursion is attendance of a conference and/or seminar, students will attend all such meetings.

While on mission trips, students are expected to comply with the standards of conduct and dress that are appropriate for Christians in the culture in which they are serving. Students are also expected to sign any waivers that are applicable to their work and travel. When work is to be done on any school trip, students are expected to work diligently without complaining. All conduct that is prohibited in this handbook in the section dealing with discipline is also prohibited on student excursions. Transportation with the opposite sex is forbidden. All student sponsored excursions will be accompanied by a member of the faculty or administration of the university. When such trips are for academic credit, students are responsible to meet the academic requirements specified by the supervising professor.

## Student Discipline

Southeastern Baptist Theological Seminary is a Christian institution whose primary purpose is to conduct a program of graduate and undergraduate theological education designed to equip women and men students for effective Christian leadership in church related ministries and other areas where theological training is required.

This purpose assumes a community and lifestyle that are in the world but not of the world. The distinguishing factor is commitment to the vocation of the Christian ministry which signifies not only the role of a Christian but also the role of spiritual and moral leadership in the church of Jesus Christ. Southeastern Baptist Theological Seminary is also a Southern Baptist institution. Therefore, those who are part of Southeastern are expected to adhere to the behavioral standards that are normative for Southern Baptist ministers.

Disciplinary action may result whenever students are involved in the violation of the personal or property rights of others, or in behavior which is not acceptable in the Southeastern community. The following are examples of conduct which is unacceptable in the Southeastern community and subject to disciplinary action:

- A. Academic misconduct such as plagiarism, cheating, or making false representations.
- B. Use or possession of beverage alcohol, or possession of illegal drugs or controlled substances.
- C. Homosexual behavior or heterosexual misconduct, including possession or viewing of any pornographic material.
- D. Neglect of personal financial obligations.
- E. Giving false information or altering records.
- F. Theft, intentional abuse, or destruction of personal or Southeastern property.
- G. Neglect, disregard or breach of established seminary/college policies which govern the use of any seminary/college properties or facilities.
- H. Behavior (verbal, physical, emotional) which is demeaning, harassing, or abusive of another person; and behavior that is profane or vulgar.
- I. Disrespect or abuse directed toward any faculty member, school administrator, or staff person.
- J. The use of tobacco products anywhere on seminary property.
- K. True ministers of the Gospel must set the standard by modeling biblical marriage. Any active student experiencing a divorce must notify the Dean of Students, and withdraw from classes and campus housing for a period of one year before applying for readmission.
- L. Students and their families are expected to dress in modest attire everywhere on campus. The seminary's position is that immodest clothing damages one's Christian testimony, so clothes such as short skirts, and tank tops are discouraged.

Students involved in civil infractions are accountable to civil authorities, but may also be subject to discipline by Southeastern.

Prompt and decisive action is required in cases which involve disciplinary procedures. Therefore, the Director of Student Life, the Dean of Students, or the President may issue at once an automatic suspension to a student charged with an offense pending a full investigation of the matter.

## Student Discipline

Southern Baptist Theological Seminary is a Christian institution whose primary purpose is to conduct a program of graduate and undergraduate theological education designed to equip young and men students for effective Christian leadership in church related ministries and other areas where theological training is required.

This purpose requires a community and lifestyle that are in the world but not of the world. The distinguishing factor in commitment to the vocation of the Christian ministry which requires not only the role of a Christian but also the role of spiritual and moral leadership in the church of Jesus Christ. Southern Baptist Theological Seminary is also a Southern Baptist institution. Therefore, those who are part of Seminary are expected to adhere to the biblical standards thereof in dealing for Southern Baptist ministers.

Disciplinary action may result whenever students are involved in the violation of the general or proper rules of ethics or in behavior which is not acceptable in the Southern Baptist community. The following are examples of conduct which is unacceptable in the Southern Baptist community and subject to disciplinary action:

- A. Academic misconduct such as plagiarism, cheating or making false representations.
- B. Use or possession of beverage alcohol, or possession of illegal drugs or controlled substances.
- C. Non-accusal behavior or intentional misconduct, including possession or viewing of any pornographic material.
- D. Disrespect of general theological opinions.
- E. Giving false information or altering records.
- F. Theft, intentional abuse or destruction of personal or Seminary property.
- G. Placing a charge or breach of established community college policies which could result in the loss of any community college privileges or facilities.
- H. Behavior (verbal, physical, emotional) which is demeaning, harassing or abusive of another person, and behavior that is obscene or vulgar.
- I. Disrespect of those directed toward any faculty member, school administrator, or staff member.
- J. The use of tobacco products anywhere on Seminary property.
- K. The violation of the local laws or the standards of modeling biblical marriage. Any active student expecting a divorce must notify the Dean of Students, and withdraw from classes and campus housing for a period of one year before applying for readmission.
- L. Students and their families are expected to dress in modest attire everywhere on campus. The student's position is not intended clothing damage one's Christian testimony, to others such as short skirts, and tank tops are discouraged.

Students involved in civil infractions are accountable to civil authorities, but may also be subject to discipline by Seminary.

Prompt and decisive action is required in cases which involve disciplinary procedures. Therefore, the Director of Student Life, the Dean of Students, or the President may want to take an automatic response to a student charged with an offense pending a full investigation of the matter.



The intention of the seminary is to make all student discipline occasions for learning and growth in Christlikeness. Most disciplinary action will be handled by the Director of Student Life. If a student feels this action to be unjust the student may appeal to the Dean of Students. If still not satisfied with the decision, the student may go to the President of the institution to appeal to him.

Upon the direction of the President a committee may be appointed to hear the appeal of the student; however, this action is not a necessity but only an option. The President of the institution has full authority to handle all cases as he deems necessary.

If the President chooses to call a meeting of the Student Discipline Committee to hear an appeal, it will be comprised of the Director of Student Life (who will serve as Chairman), the Dean of Students, one seminary professor, one college professor, one seminary student, and one college student.

Anyone witnessing what he/she believes to be an infraction should inform the appropriate Southeastern personnel (faculty member, administrative officer, etc.) and lovingly confront the perpetrator in accord with the procedure described in Matthew 18. The witness and/or the appropriate Southeastern personnel will also inform the Director of Student Life. The Director of Student Life will collect information on the charge, and meet with the student(s) and witness(es) as needed.

#### **Disciplinary Actions**

- 1. Reprimand:** A disciplinary action may be private if the offense was committed in private and affected only a few individuals. If the action committed affected many people publicly then the reprimand may occur publicly. This action may or may not require a probational period. Records of student violations and disciplinary actions may be retained during a student's enrollment. Decisions containing conditions of continued or future enrollment may be held in a student's academic record until such conditions are met.
- 2. Disciplinary Probation:** This action may be taken by the seminary to indicate to a student who has violated the seminary's standard of conduct that his/her behavior is inappropriate and is not to be repeated. Probation is notice to the violating student that if the inappropriate behavior is repeated, suspension or expulsion is likely. Probation may be for any length of time deemed appropriate by the seminary administration.
- 3. Requested Withdrawal:** Requested withdrawal is suitable in instances where questionable behavior has threatened the development of the student as a potential minister or threatened the community fellowship, but culpable deportment has not been established. Withdrawal does not imply the assessment of guilt, and therefore is normally a private matter. Withdrawal will be for a specified period of time and will normally carry stipulations regarding readmission.
- 4. Suspension:** Suspension is the right of the institution to require that a student be separated from the institution for a specified period of time. Suspension is suitable in instances where questionable behavior has threatened the development of the student as a potential minister or threatened the community fellowship. In all cases of Requested Withdrawal or Suspension, fulfillment of the discipline contracts only insures eligibility to be considered for readmission, following standard Southeastern readmission policies.
- 5. Expulsion:** Expulsion is suitable in instances where there are repeated offenses, flagrant violations of a disciplinary contract, or where the initial evidence in a case involves a civil or criminal indictment or flagrant violations of seminary/college norms. By decision of the President, expulsion may become part of a student's permanent record.

The mission of the university is to make all student disciplines occasions for learning and growth in Christlikeness. Most disciplinary action will be handled by the Director of Student Life. If a student feels this action to be unjust the student may appeal to the Dean of Students. If still not satisfied with the decision, the student may go to the President of the institution to appeal to them. Upon the direction of the President a committee may be appointed to hear the appeal of the student; however, this action is not a necessity but only an option. The President of the institution has full authority to handle all cases as he deems necessary.

If the President chooses to call a meeting of the Student Discipline Committee to hear an appeal it will be composed of the Director of Student Life (who will serve as Chairman), the Dean of Students, one senior professor, one college professor, one scholarly student, and one college student.

Anyone wishing what better bodies to be an institution should inform the appropriate personnel: general faculty member, administrative officer, staff, and faculty. You may be permitted to consult with the personnel described in Matthew 18. The various bodies are appointed by the Board of Trustees and inform the Director of Student Life. The Director of Student Life will collect information on the charges, and meet with the student(s) and witness(es) as needed.

### Disciplinary Action

1. **Reprimand:** A disciplinary action may be given if the offense was committed in private and affected only a few individuals. If the action committee should not require a public hearing the reprimand may occur privately. This action may occur without a disciplinary action. Records of student violations and disciplinary actions are maintained during a student's enrollment. Disciplinary actions containing records of committed or pending suspension may be held in a student's academic record until such conditions are met.

2. **Disciplinary Probation:** This action may be taken by the university to inform to a student who has violated the university's standard of conduct that further behavior is inappropriate and is not to be repeated. Probation is notice to the violating student that the inappropriate behavior is reported, suspension or expulsion is likely. Probation may be for any length of time deemed appropriate by the university administration.

3. **Requested Withdrawal:** Requested withdrawal is suitable in instances where disciplinary behavior has threatened the development of the student as a participant in the community following the Christian faith. The student has been notified of the withdrawal. Withdrawal does not imply the agreement of guilt, but withdrawal is not only a private matter. Withdrawal will be for a specified period of time and will require any applications requiring readmission.

4. **Suspension:** Suspension is the right of the institution to require that a student be separated from the institution for a specified period of time. Suspension is suitable in instances where disciplinary behavior has threatened the development of the student as a potential member of the community following the Christian faith. In the case of suspension, withdrawal or suspension, fulfillment of the discipline course may require slightly to be considered for readmission, following standard procedures for readmission policies.

5. **Expulsion:** Expulsion is suitable in instances where there are repeated offenses, repeated violations of a disciplinary contract, or where the initial evidence in a case involves a civil or criminal incident or illegal violations of university policy. By decision of the President, expulsion may become part of a student's permanent record.

## **On-Campus Student Organizations**

### **Fellowship of Military Chaplains**

This student organization was founded in 1992 with the following threefold purpose:

1. To provide a support group for students planning for service as military chaplains.
2. To educate chaplain candidates about topics relevant to ministry in the military.
3. To promote a heightened awareness of military chaplaincy on campus.

### **Student Leadership Team**

The Student Leadership Team is an elected body of four students seeking to minister to the needs of the Southeastern family. The main foci of the Student Leadership Team are campus prayer and community evangelism. Other programs to foster personal, family, and community growth are implemented through various kinds of religious, social, and educational opportunities. The Leadership Team works to unify the campus to accomplish the vision set forth by the Seminary President. Part of bringing about this unity includes enhancing communications between the students and the administration. Southeastern is a faculty/administration run campus which desires to make adequate decisions by being fully informed. The Student Leadership Team works as a liaison to provide this information. The team consists of a President who must be a senior Masters level student, a Vice-President who must be a Masters level student, a 2<sup>nd</sup> Vice-President and a Secretary/Treasurer, one of which must be a college student.

### **Southeastern Women's Fellowship (SWF)**

SWF is an organization made up of student wives and women students and is dedicated to ministering to their needs. SWF meets monthly in the Ledford Center, where the ladies hear outstanding speakers and share fellowship. Other ministries include Bible study, clothing ministry, outreach, bread ministry, craft & bake sales, and much more.

### **Doulos**

The Doulos organization is a group which meets each week in the Ledford Center to share the Gospel through door to door evangelism throughout the town of Wake Forest.

### **Homeschoolers in Ministry**

Homeschoolers in Ministry (HIM) operates to bring together homeschoolers to participate in a community environment which serves to benefit the entire group. They offer many activities and family-oriented functions.

# On-Campus Student Organizations

## Leadership at Military Colleges

This student organization was founded in 1992 with the following stated purpose:

1. To provide a support group for students planning for service as military leaders.
2. To educate students on issues relevant to military in the military.
3. To promote a heightened awareness of military leadership on campus.

## Student Leadership Team

The Student Leadership Team is an elected body of four students seeking to minister to the needs of the student body. The main focus of the Student Leadership Team is to create a positive and supportive environment. Our emphasis is to foster personal, family, and community growth and development through various kinds of activities, social, and educational opportunities. The Leadership Team works to unify the campus to work with the vision set forth by the University President. Part of working with this unity includes enhancing communication and between the student and the administration. Support is a leadership philosophy that we practice which strives to make student decisions by being fully informed. The Student Leadership Team works as a team to provide this information. The team consists of a President who must be a senior, a Vice President who must be a junior, a Vice President who must be a sophomore, and a Secretary/Recorder, one of which must be a college student.

## Student Leadership Team's Philosophy (SLT)

SLT is an organization made up of student wives and women students who is dedicated to ministering to their needs. SLT meets weekly in the Student Center where the ladies have outstanding speakers and share their trip. Other activities include Bible study, clothing, beauty, health, food, ministry, craft & bake sales, and much more.

## Devotion

The Devotion organization is a group which meets each week in the Student Center to share the Gospel through song to their evangelists throughout the town of West Point.

## Homecoming in Military

Homecoming in Military (HIM) operates to bring together homecoming to participants in a community environment which serves to benefit the entire group. They offer many activities and family-oriented functions.

### International Student Fellowship

The International Student Fellowship provides an opportunity for all international students to fellowship with one another and encourage one other in adjusting to their new environment. It also serves as an outlet for North American students to meet international students.

### Southeastern Christian Martial Arts

Southeastern Christian Marital Arts serves as an opportunity for students to exercise, and learn self-discipline and self-control. This group provides a friendly environment of encouragement to learn skills in the Martial Arts in a Christian atmosphere. Scripture memory and prayer times are incorporated with physically challenging work-outs.

### American Association of Christian Counselors (AACC)

AACC is an organization designed to encourage Christian Counselors in their efforts to minister to those in need.

### Patristics Club

This club offers an opportunity for those interested in the church fathers to come together and discuss theological issues that are relevant to this era of the church.

### Baptist Student Union

The Baptist Student Union is operated mainly by college students and offers opportunities for spiritual growth and service in an exciting environment of fellowship. Their meetings will be announced in the NewsLine each semester.

International Student Fellowship

The International Student Fellowship provides an opportunity for all international students to... fellowship with our writer and encourage one other in adjusting to their new environment. It also serves as an outlet for North American students to meet international students.

International Christian Student Arts

International Christian Student Arts serves as an opportunity for students to exercise and learn self-discipline and self-control. This group provides a friendly environment of encouragement to learn skills in the liberal Arts in a Christian atmosphere. Students exercise and enjoy their art in a relaxed and physically challenging work-out.

American Association of Christian Counselors (AACC)

AACC is an organization devoted to encourage Christian Counselors in their efforts to minister to those in need.

Principles Club

This club offers an opportunity for those interested in the church before to come together and discuss theological issues and are relevant to the work of the church.

Faculty Student Union

The Faculty Student Union is operated mainly by college students and offers opportunities for personal growth and service in an exciting environment of fellowship. Their interests will be announced in the newsletter each semester.

Employment  
Service  
Church

## WHERE TO FIND INFORMATION Area Code: 919

863-8365  
863-8317

### Switchboard Operator

Financial Aid Office 863-8310

The switchboard serves as the primary communications center for the campus. In addition to coordinating the telephone service, the operator has access to general information concerning campus offices as well as addresses, phone numbers, and class schedules of students. The switchboard is usually open Monday-Friday from 7:30 a.m. to 6:00 p.m. during regular semesters. To reach the switchboard while on campus, dial "0," and off campus dial 919-556-3101. The following offices and information-sources may be dialed directly at the numbers shown.

Housing Office 863-8300

Academic Information

Academic Vice President  
or Registrars Office

863-8225  
863-8215

Activities

Student Life

863-8305

Admissions

Admissions Office

863-8280

Audiovisuals

Audiovisual Services

863-8259

Billing

Business Office

863-8207

Bookstore

Lifeway Christian Bookstore

556-3481

Calendar

Public Relations

863-8270

Child Care

Child Development Center

863-8248

Counseling

Academic  
Career  
Financial  
Fitness  
Personal

Academic Vice President  
Ministry Referral  
Employment  
Sports and Facility Manager  
Director of Student Life

863-8225  
863-8317  
863-8365  
863-8309  
863-8305

Discipline

Director of Student Life

863-8305

Doctoral Studies

Academic Vice President

863-8225

Emergencies

Clinic  
Student  
Security

Health Center  
Student Life  
Security

863-8245  
863-8305  
302-2485

Publications

Public Relations

863-8270

WHERE TO FIND INFORMATION  
Area Codes 919

The switchboard serves as the primary communications center for the campus. In addition to providing the telephone service, the operator has access to general information concerning campus offices as well as addresses, phone numbers, and class schedules of students. The switchboard is usually open Monday-Friday from 7:30 a.m. to 5:00 p.m. during regular semester. To reach the switchboard while on campus, dial "0", and off campus dial 919-356-3191. The following office and information sources may be dialed directly at the numbers shown:

Area Code	Office/Department	Service/Category
863-8232	Academic Vice President	Academic Information
863-8212	Registrar Office	Academic Information
863-8302	Student Life	Activities
863-8280	Admissions Office	Admissions
863-8299	Audiovisual Services	Audiovisuals
863-8207	Business Office	Billing
756-3481	Lifeway Christian Bookstore	Bookstore
863-8270	Public Relations	Calendar
863-8248	Child Development Center	Child Care
863-8225	Academic Vice President	Counseling
863-8217	Ministry Relations	Academic
863-8362	Employment	Career
863-8309	Sports and Facility Manager	Financial
863-8202	Director of Student Life	Fitness
863-8202	Director of Student Life	Personal
863-8219	Academic Vice President	Discipline
863-8245	Health Center	Doctoral Studies
863-8202	Student Life	Emergencies
302-3482	Security	Clinic
		Student
		Security

Switchboard Operator



Employment		
Secular	Student Employment Office	863-8365
Church	Ministry Referral	863-8317
Financial Aid	Financial Aid Office	863-8310
General Information	Switchboard	556-3101
Graduation Requirements	Dean of Students Office	863-8306
Guest Reservations	Housing Office	863-8400
Housing	Housing Office	863-8400
Identification Cards	Student Life Office	863-8305
Information	Switchboard	556-3101
Injury or Illness	Health Center	863-8245
International Students	Student Life	863-8305
Library	Circulation Desk	863-8251
Library	Reference Desk	863-8258
Loans	Financial Aid	863-8310
Lost and Found	Switchboard	556-3101
Ministry Positions	Ministry Referral	863-8317
Name Change	Registrar's Office	863-8215
Notary Public	Business Office	863-8207
Organizations	Student Life	863-8305
Orientation	Student Life	863-8305
Parent's Night Out	Student Life	863-8305
Parking	Physical Plant	863-8420
Postal Service	Post Office	863-8311
Publications	Public Relations	863-8270

Student Employment Office 863-8365  
 Ministry Retreat 863-8317  
 Financial Aid Office 863-8310  
 Switchboard 256-3101  
 Loan of Students Office 863-8306  
 Housing Office 863-8400  
 Housing Office 863-8400  
 Student Life Office 863-8302  
 Switchboard 256-3101  
 Health Center 863-8245  
 Student Life 863-8302  
 Circulation Desk 863-8251  
 Resource Desk 863-8258  
 Financial Aid 863-8310  
 Switchboard 256-3101  
 Ministry Retreat 863-8317  
 Registrar's Office 863-8215  
 Business Office 863-8307  
 Student Life 863-8302  
 Student Life 863-8302  
 Student Life 863-8302  
 Physical Plant 863-8420  
 Post Office 863-8311  
 Public Relations 863-8270

Employment  
 Switchboard  
 Financial Aid  
 General Information  
 Question Requirements  
 Loan Reservations  
 Housing  
 Identification Cards  
 Information  
 Injury or Illness  
 International Students  
 Library  
 Library  
 Loans  
 Loan and Found  
 Ministry Positions  
 Name Changes  
 Newby Public  
 Organizations  
 Orientation  
 Student's Night Out  
 Parking  
 Post Office  
 Publications

Recreation	Ledford Center	863-8300
Registration	Registrar's Office	863-8215
Scholarships	Financial Aid	863-8310
School Supplies	LifeWay Christian Bookstore	556-3481
Security	Security	302-2485
Special Events	Public Relations	863-8270
Switchboard	Switchboard	556-3101
Telephone Numbers	Switchboard	556-3101
Tours of Campus	Admissions Office	863-8280
Transcripts	Registrar's Office	863-8215
Veteran Benefits	Registrar's Office	863-8215

863-8390	Leidner Center
863-8312	Registrar's Office
863-8310	Financial Aid
256-3181	Lifeway Christian Bookstore
302-3422	Security
863-8320	Public Relations
256-3101	Switchboard
256-3101	Switchboard
863-8380	Admissions Office
863-8322	Registrar's Office
863-8322	Registrar's Office

Registrar
Registration
Scholarships
School Supplies
Security
Special Events
Switchboard
Telephone Numbers
Tours of Campus
Transcripts
Vendor Booths

# Southeastern Publications

## **Campus Directory**

The Directory is a pictorial handbook of students, faculty, and administrative personnel, with addresses, phone numbers, and other biographical information. It is a publication of the Public Relations Office.

## **Catalogs**

The Catalog contains information on the educational policies and programs of the seminary. It is published by the Public Relations Office and is available upon request from the Admissions Office.

## **Newsline**

The Newsline is a bi-monthly newsletter announcing campus activities and events and is published by the Student Life Office.

## **Olive Press**

The Olive Press is published in the spring and winter and serves as a news journal of the exciting things God is doing in and through the Southeastern family and the Southern Baptist Convention.

## **Outlook**

Outlook is a general interest/alumni magazine, published annually by the Public Relations Office. Upon request, copies are sent gratis to alumni, trustees, and other friends of the seminary.

## Southeastern Publications

### Campus Directory

The Directory is a practical handbook of students, faculty, and administrative personnel, with addresses, phone numbers, and other biographical information. It is a publication of the Public Relations Office.

### Catalog

The Catalog contains information on the educational policies and programs of the seminary. It is published by the Public Relations Office and is available upon request from the Admissions Office.

### Newsline

The Newsline is a bi-monthly newsletter announcing campus activities and events and is published by the Student Life Office.

### Five Press

The Five Press is published in the spring and winter and serves as a news journal of the exciting things God is doing in and through the Southeastern family and the Southern Baptist Convention.

### Outlook

Outlook is a general interdenominational magazine, published annually by the Public Relations Office. Upon request, copies are sent gratis to alumni, trustees, and other friends of the seminary.

